

# Valena™ Life

## Connected wireless control for roller shutters

Cat. Nos: 7 521 91 - 7 522 91 - 7 523 91

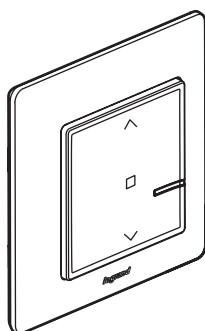

### 1. USE

- Zone or centralised control for wired roller shutter switches.
- Fixes directly on the wall or screws onto a flush-mounting box. Multi-gang versions can be combined with other wiring accessories.
- Fits on a piece of furniture (movable).
- Can control up to 20 roller shutter switches.

### 2. RANGE

Description	White	Ivory	Aluminium
Connected wireless control for roller shutters. Supplied complete with battery. Equipped with an LED indicator (configuration) and a RESET button (hidden) used to return to factory settings. Repositionable self-adhesive fixings supplied.	7 521 91	7 522 91	7 523 91

### 3. DIMENSIONS (mm)

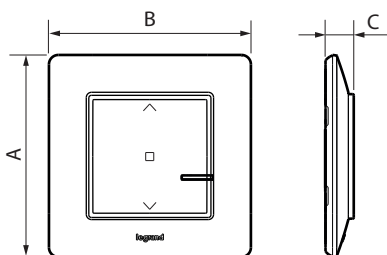

Cat. Nos	A	B	D
7 521 91 - 7 522 91 - 7 523 91	86	86	12

### 4. OPERATION

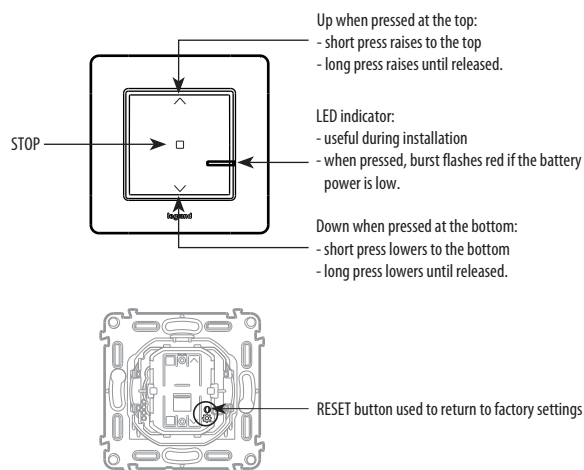

### 5. TECHNICAL CHARACTERISTICS

- 5.1 Mechanical characteristics**  
 Protection against impacts: IK 02  
 Protection against solid bodies/liquids:  
 - IP 20 without plate and rocker plate  
 - IP 40 for assembled product
- 5.2 Material characteristics**  
 Plate: ABS  
 Sub-plate: PC  
 Rocker plate: ABS  
 Mechanism with grid: Fibreglass-reinforced (10%) PC  
 Halogen-free  
 UV resistant  
 Self-extinguishing: 650°C/30 s
- 5.3 Electrical characteristics**  
 Powered by a CR2032 - 3 V lithium battery (supplied)  
 Battery life: 8 years for 10 activations a day  
**ZigBee radio technology** frequency: 2.4 GHz to 2.4835 GHz  
 Power level: < 100 mW  
 Wireless mesh network, self-adaptive and secure (AES 128), conforming to standard IEEE 802.15.4 (LR-WPAN)
- 5.4 Climate characteristics**  
 Usage temperature: + 5° C to + 45° C  
 Storage temperature: 0° C to + 45° C

## 6. CARE

Clean the surface with a cloth.  
Do not use acetone, tar-removing cleaning agents or trichloroethylene.  
Resistant to the following products: Hexane (EN 60669-1), methylated spirit, soapy water, diluted ammonia, bleach diluted to 10%, window-cleaning products, pre-impregnated wipes.

**Caution:** Always test before using special cleaning products.

The plates must not be painted.



Take care to recycle the battery appropriately

## 7. ACCESSORIES

0 648 71: Repositionable adhesive for wireless control (x 4 supplied)

## 8. STANDARDS AND APPROVALS

The undersigned, LEGRAND, declares that the radio-electric equipment type (7 521 91 - 7 522 91 - 7 523 91) complies with directive 2014/53/EU. The full text of the EU declaration of conformity is available on the following website: [www.legrandoc.com](http://www.legrandoc.com)