

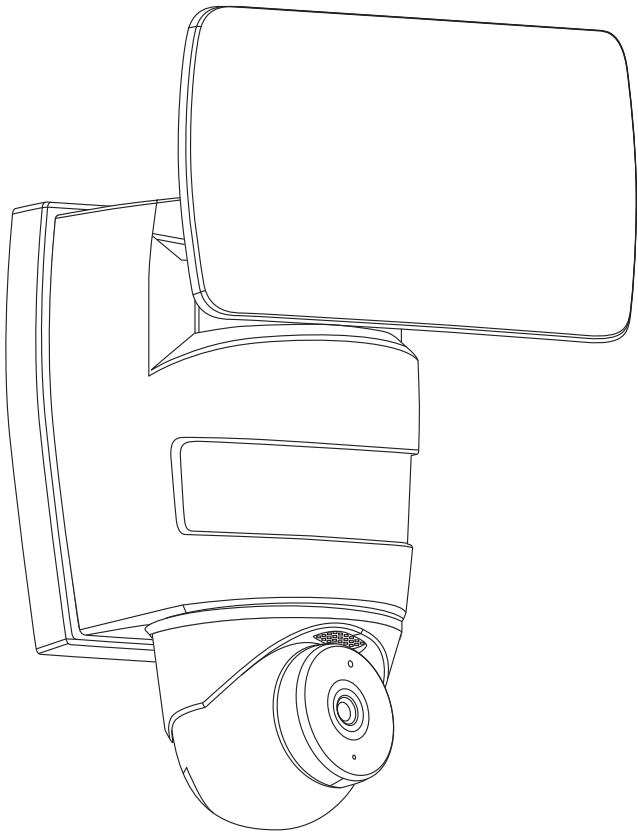

SMART⁺ WIFI FLOOD

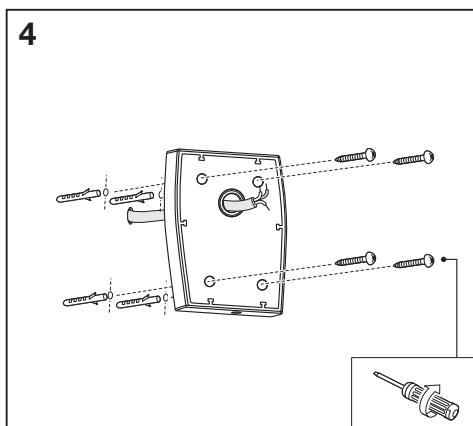

	EAN	W	lm	K	IP	° (°C)	V~	mA	Hz	PF
SMART OUTD WIFI FLOOD CAMERA 830 DG	4058075478312	24	1800	3000	44	-20...+40	220-240	104	50/60	>0.5

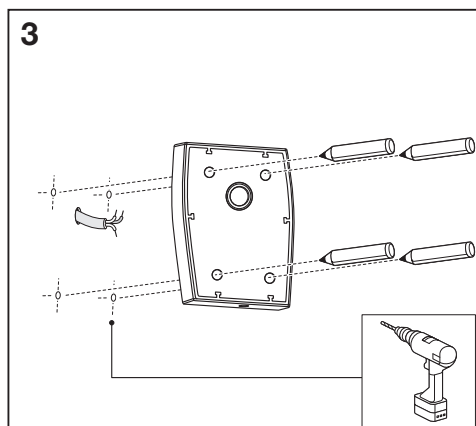
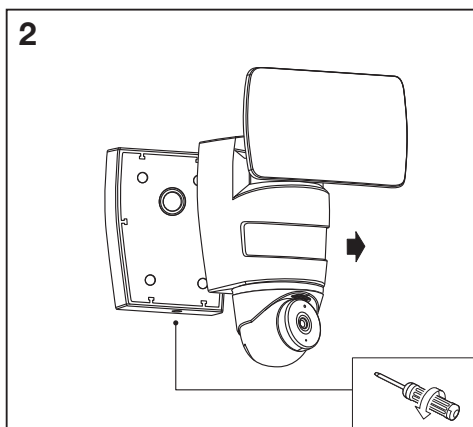
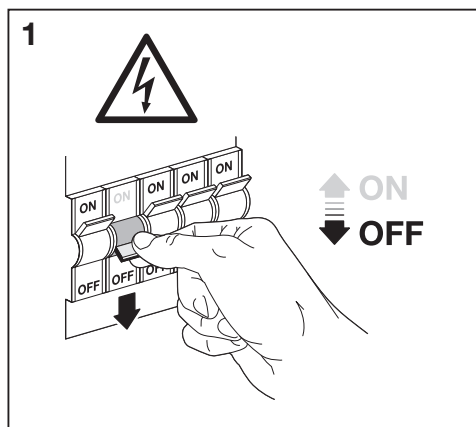
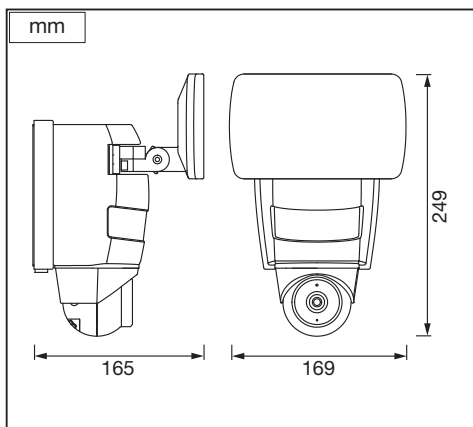
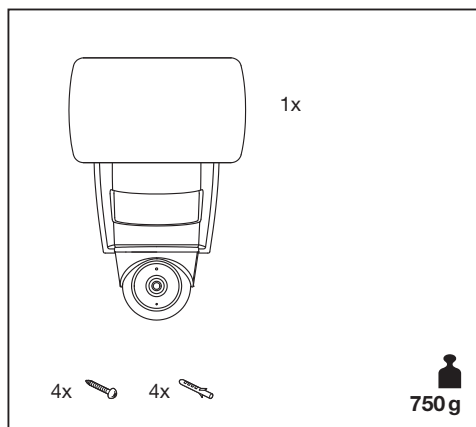

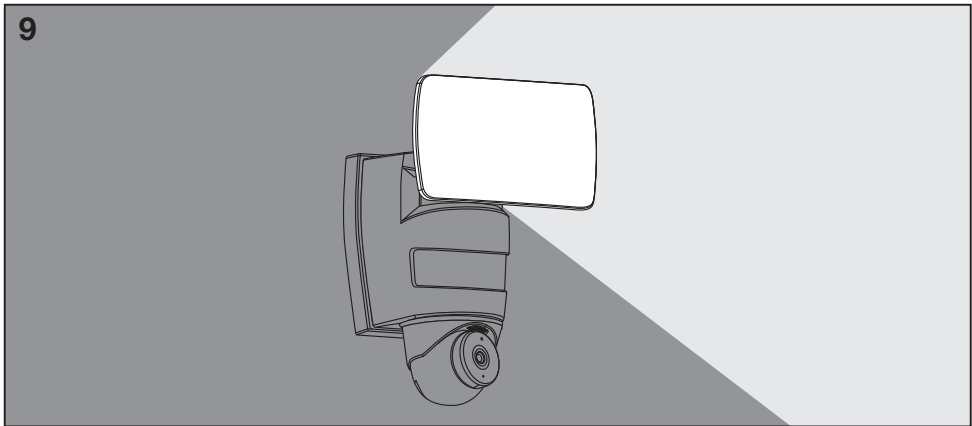
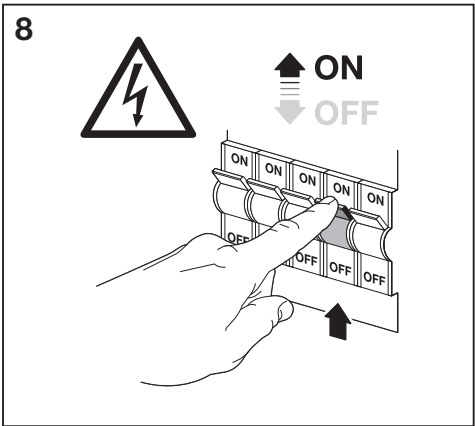
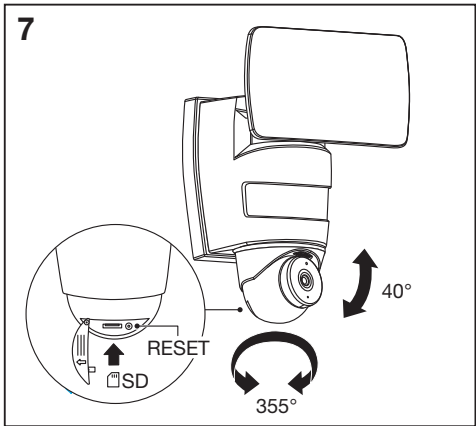
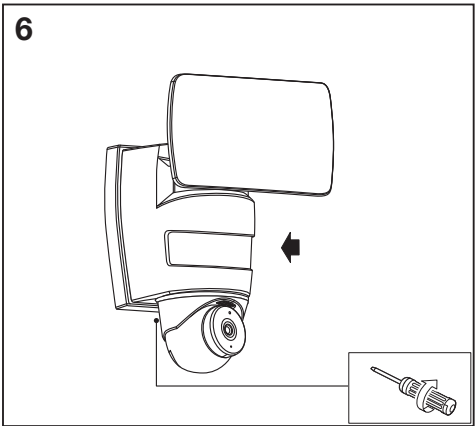
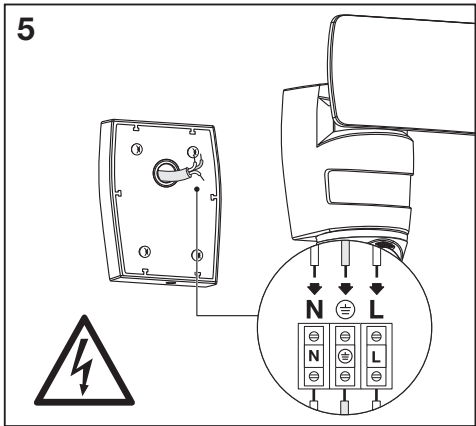

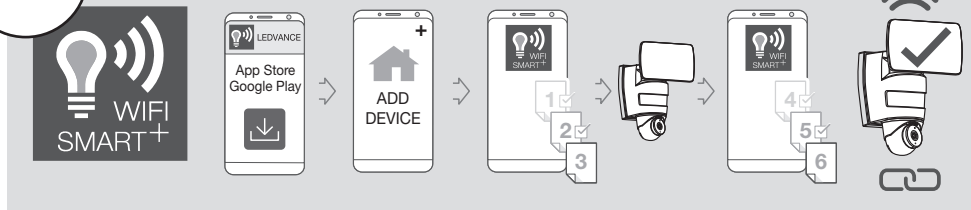

OPTIONAL

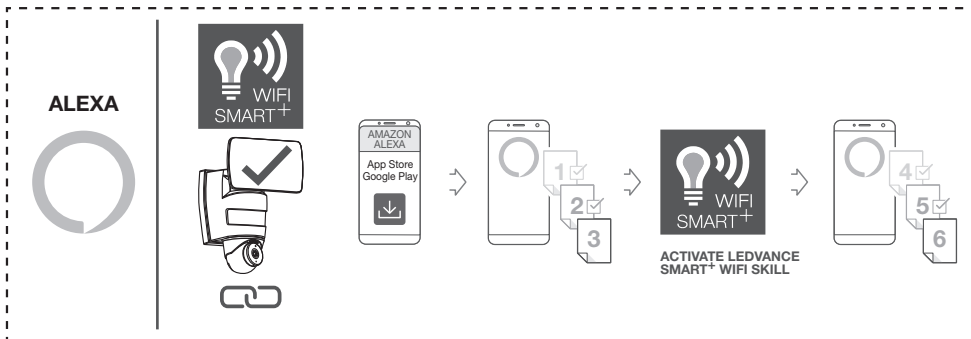
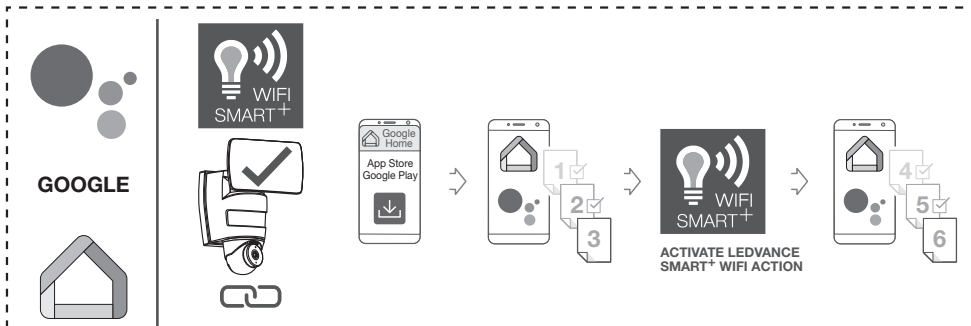

TROUBLESHOOTING



DECREASE DISTANCE

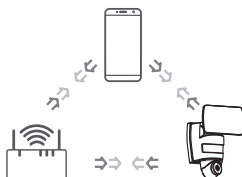

RESET

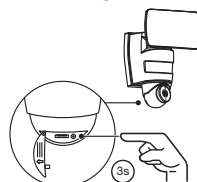

<https://www.ledvance.com/consumer/smart/faq/>

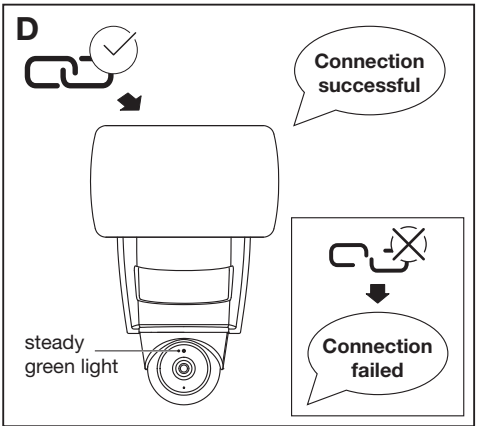
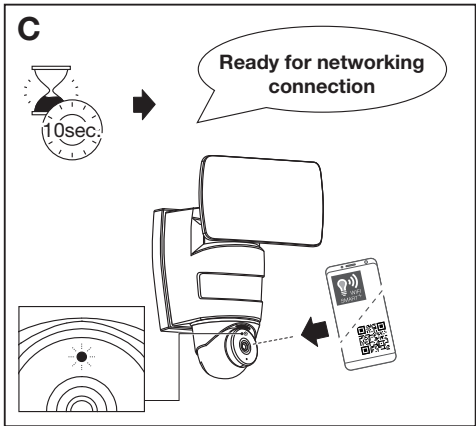
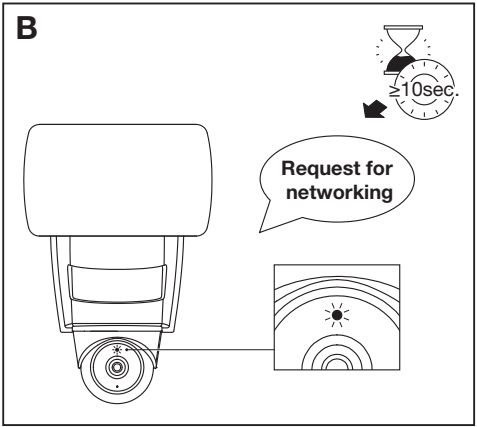
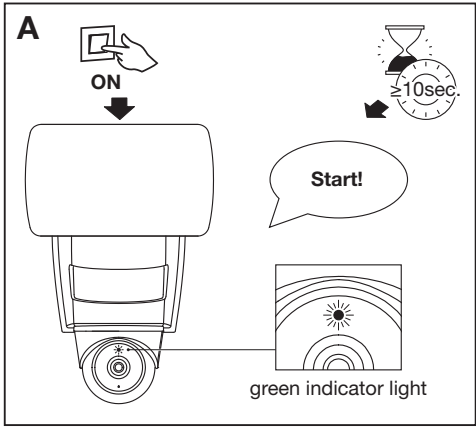

HOW TO USE

All functions are selected and used via the LEDVANCE App.

LIGHT SETTINGS

Time settings

- The time (switch-off delay) can be set from 5s – 360s
- Every detected movement re-activates the light

Twilight settings

The brightness response threshold (twilight) can be infinitely varied from approx. 10 – 500lux

Factory settings

- Time setting: 120s
- Twilight setting: 40lux

AIMING FLOODLIGHT HEAD

The Floodlight head can be adjusted

- Up/down 180°
- Left/right 150°

CAMERA FUNCTION

- The camera films a sequence when the sensor is triggered
- The filmed sequence is saved on the memory card or cloud storage and can be retrieved at any time
- The recorded data is saved on the unit's memory card or cloud storage
- A QR code is generated on the smartphone or tablet which can be read by another smartphone or tablet
- Once the sensor has been triggered, the user receives a push notification via the LEDVANCE App (can be deactivated)
- Open LEDVANCE App
- Use image display and intercom system
- Switch between HD and SD mode possible
- If HD image shows delay, SD is recommended

AIMING CAMERA

The camera can be adjusted

- Up/down 40°
- Left/right 355°

ALARM FUNCTION

- Acoustic alarm signal reacting on detected movement
- Sensor sensitivity can be adjusted (low, medium, high)

FOUR SECURITY MODES

Low level:

- System default lighting environment: 40lux
- Sensor distance: 5m
- Lumen: 400lm
- Lighting time: 120s

Middle level:

- System default lighting environment: 40lux
- Sensor distance: 8m
- Lumen: 800lm
- Lighting time: 120s

High level:

- System default lighting environment: 40lux
- Sensor distance: 12m
- Lumen: 1800lm
- Lighting time: 120s

Custom mode:

The default of custom mode is the same as Low mode. You can adjust the data to your preferences.

Further information on the functions and setting options can be found in the LEDVANCE App.

INSERT SD MEMORY CARD

- Undo retaining screw and remove cover
- Insert SD memory card
- Fit cover and tighten retaining screw

RESTORING FACTORY SETTINGS

- Undo retaining screw and remove cover
- Using the needle, press reset button for approx. 7s until the signal sounds

While resetting:

Status LED lights up green
→ Flashes fast

After resetting:

Acoustic signal one time
Status LED flashes green
→ Flashes slowly

- Open LEDVANCE App
- Clear camera in LEDVANCE App
- Re-configure unit
- Fit cover and tighten retaining screw



IP44 RoHS

C10567405
G11100642
04.09.2020



LEDVANCE GmbH
Steinerne Furt 62
86167 Augsburg, Germany
www.ledvance.com